

## DOP-SW hp-026

**1. Unique identification code of the product-type:**

Multi Wall Metal System Chimney  
EN 1856-1:2009

**2. Type, batch or serial number or any other element allowing identification of the construction product as required under Article 11(4):**

### DINAK SW hp

1.0 Model 1.4404 / 316L	Ø 80-300	T200 H1 W V2 L50040 O40
1.0 Model 1.4404 / 316L	Ø 350-450	T200 H1 W V2 L50050 O60
1.0 Model 1.4404 / 316L	Ø 500-600	T200 H1 W V2 L50060 O80
2.0 Model 1.4521 / 444	Ø 80-300	T200 H1 W V2 L99040 O40
2.0 Model 1.4521 / 444	Ø 350-450	T200 H1 W V2 L99050 O60
2.0 Model 1.4521 / 444	Ø 500-600	T200 H1 W V2 L99060 O80
3.0 Model 1.4162 / S32101	Ø 80-300	T200 H1 W V2 L99050 O40
3.0 Model 1.4162 / S32101	Ø350-450	T200 H1 W V2 L99050 O60
3.0 Model 1.4162 / S32101	Ø500-600	T200 H1 W V2 L99060 O80
4.0 Model 1.4301 / 304	Ø 80-300	T200 H1 D Vm L20040 O40
4.0 Model 1.4301 / 304	Ø 350-450	T200 H1 D Vm L20050 O60
4.0 Model 1.4301 / 304	Ø 500-600	T200 H1 D Vm L20060 O80

**3. Intended use or uses of the construction product, in accordance with the applicable harmonised technical specification, as foreseen by the manufacturer:**

Convey the products of combustion from heating appliances to the outside atmosphere

**4. Name, registered trade name or registered trade mark and contact address of the manufacturer as required under Article 11(5):**

DINAK S.A.  
Camiño do Laranxo, 19  
36216, Vigo (SPAIN)  
dinak@dinak.com

**5. Where applicable, name and contact address of the authorised representative whose mandate covers the tasks specified in Article 12(2):**

Not applicable

**6. System or systems of assessment and verification of constancy of performance of the construction product as set out in CPR, Annex V:**

System 2+  
System 4 (for terminals)

**7. Notified factory production control certification body TÜV SÜD Industrie Service GmbH, No.0036, performed the initial inspection of the manufacturing plant and of factory production control and the continuous surveillance, assessment and evaluation of factory production control and issued the certificate of conformity of the factory production control**

**8. Declared performance**

Essential Characteristics	Performance	Harmonized technical specification
---------------------------	-------------	------------------------------------

## DOP-SW hp-026

<b>Compressive strength</b> Chimney Sections, fittings and supports	Up to 53 m (See annex) See annex	EN 1856-1:2009
<b>Resistance to fire</b>	Models 1.0, 2.0, 3.0 and 4.0: Ø80-300: T200 – O40 Ø350-450: T200 – O60 Ø500-600: T200 – O80	EN 1856-1:2009
<b>Gas tightness/leakage</b>	Models 1.0, 2.0, 3.0 and 4.0: H1	EN 1856-1:2009
<b>Flow resistance of chimney sections, fittings and terminals</b>	According to EN 13384-1	EN 1856-1:2009
<b>Thermal resistance</b>	0 m <sup>2</sup> K/W	EN 1856-1:2009
<b>Thermal shock resistance</b> Soot fire resistance	Models 1.0, 2.0, 3.0 and 4.0: No	EN 1856-1:2009
Thermal performance under normal operating conditions	Models 1.0, 2.0, 3.0 and 4.0: T200	
<b>Flexural tensile strength (only for means of connection for chimney sections and fittings)</b>	Up to 58 m ( see annex)	EN 1856-1:2009
<b>Non vertical installation</b>	Maximum offset between supports: 3 m at 90° (see annex)	EN 1856-1:2009
<b>Components subject to wind load</b>	Maximum free standing height: 3 m above last support (see annex) Maximum spacing between lateral supports: 4 m (see annex)	EN 1856-1:2009
<b>Durability</b> Water and vapour diffusion resistance	Models 1.0, 2.0, 3.0 and 4.0: Yes	EN 1856-1:2009
Condensate penetration resistance	Models 1.0, 2.0, 3.0 and 4.0: Yes	
Against corrosion	Models 1.0, 2.0 and 3.0: V2 Model 4.0: Vm	
<b>Freeze thaw resistance</b>	Yes	EN 1856-1:2009

**9. The performance of the product identified in points 1 and 2 is in conformity with the declared performance in point 8.**

**This declaration of performance is issued under the sole responsibility of the manufacturer identified in point 4.**

**Signed for and on behalf of the manufacturer by:**

Íñigo A. Canoa (General Manager)

Vigo, 6<sup>th</sup> June 2013

## DOP-SW hp-026

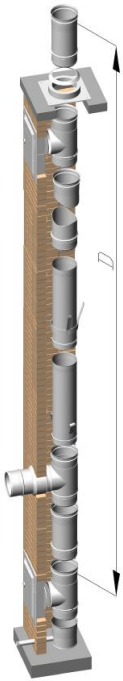

	COMPRESSION STRENGTH*		TENSILE STRENGTH	
	Material	Height – Size D (m)	Material	Height (m)
ND (mm)		1.4301 / 304; 1.4404 / 316L; 1.4521 / 444; 1.4162 / S32101		
	80	72		58
	100	58		47
	110	53		42
	111	52		42
	120	48		39
	125	46		37
	130	45		36
	139	42		33
	140	41		33
	150	39		31
	153	38		30
	160	36		29
	167	35		28
	175	33		26
	180	32		26
	200	29		23
	230	25		20
	250	23		18
	280	20		16
300	19		15	

\* In case a higher resistance is required, check with Dinak the possibility of installing a reinforced Tee

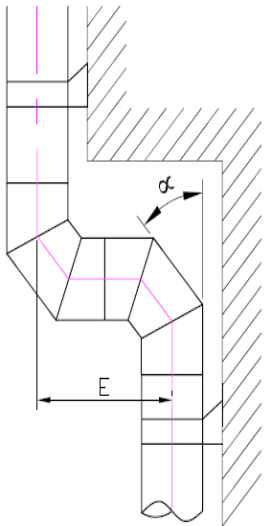

	NON VERTICAL INSTALLATION	
	Material	Maximum length of the slope – Size E (m)
ND (mm)		Maximum deflection $\alpha$ (°)
		1.4301 / 304; 1.4404 / 316L; 1.4521 / 444; 1.4162 / S32101
	80	90
	100	90
	110	90
	111	90
	120	90
	125	90
	130	90
	139	90
	140	90
	150	90
	153	90
	160	90
	167	90
	175	90
	180	90
	200	90
	230	90
	250	90
280	90	
300	90	

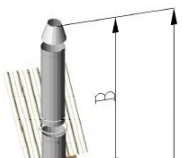

**DOP-SW hp-026**

		<b>WIND LOAD RESISTANCE</b>		
		<b>Configuration 1 (flat wall supports 086 with a self-standing support 861 at highest position)</b>		
		Max number of straight elements (020) between supports (Size A)	Max. Length from last support. (m) (Size B)	
Material		1.4301 / 304; 1.4404 / 316L 1.4521 / 444; 1.4162 / S32101	AISI 304 / 1.4401	1.4404 / 316L 1.4521 / 444; 1.4162 / S32101
ND (mm)	200	4	3	2.5
	230	4	3	2.5
	250	4	3	2.5
	280	4	3	2.5
	300	4	3	2.5

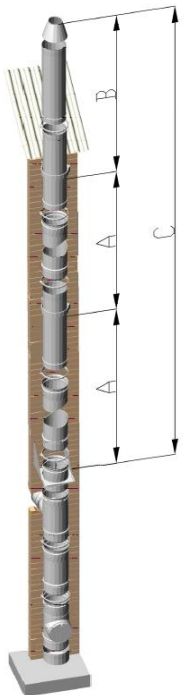

		<b>Configuration 2 (flat wall supports 086)</b>	
		Max number of straight elements (020) between supports (Size A)	Max. Length from last support. (m) (Size B)
Material		1.4301 / 304; 1.4404 / 316L; 1.4521 / 444; 1.4162 / S32101	
ND (mm)	80	4	1.5
	100	4	1.5
	110	4	1.5
	111	4	1.5
	120	4	1.5
	125	4	1.5
	130	4	1.5
	139	4	1.5
	140	4	1.5
	150	4	1.5
	153	4	1.5
	160	4	1.5
	167	4	1.5
	175	4	1.5
	180	4	1.5
	200	4	1.5
	230	4	1.5
250	4	1.5	
280	4	1.5	
300	4	1.5	

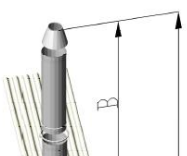

## DOP-SW hp-026

Configuration 3 (flat adjustable supports 831)		
Distance to wall: 70-120 mm		
	Max number of straight elements (Ø20) between supports (Size A)	Max. Length from last support. (m) (Size B)
Material	1.4301 / 304; 1.4404 / 316L; 1.4521 / 444; 1.4162 / S32101	
80	3	1.5
100	3	1.5
110	3	1.5
111	3	1.5
120	3	1.5
125	3	1.5
130	3	1.5
139	3	1.5
140	3	1.5
150	3	1.5
153	3	1.5
160	3	1.5
167	3	1.5
175	3	1.5
180	3	1.5
200	3	1.5
230	3	1.5
250	3	1.5
280	3	1.5
300	3	1.5

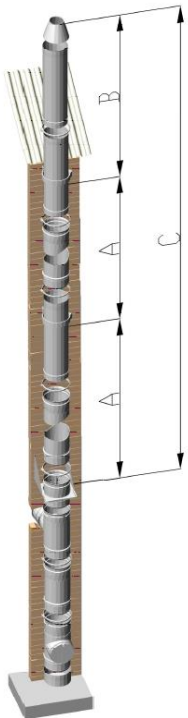

Configuration 4 (flat short cuttable supports 836)		
Distance to wall: 100-250 mm		
	Max number of straight elements (Ø20) between supports (Size A)	Max. Length from last support. (m) (Size B)
Material	1.4301 / 304; 1.4404 / 316L; 1.4521 / 444; 1.4162 / S32101	
80	3	1.5
100	3	1.5
110	3	1.5
111	3	1.5
120	3	1.5
125	3	1.5
130	3	1.5
139	3	1.5
140	3	1.5
150	3	1.5
153	3	1.5
160	3	1.5
167	3	1.5
175	3	1.5
180	3	1.5
200	3	1.5
230	3	1.5
250	3	1.5
280	3	1.5
300	3	1.5



## DOP-SW hp-026

Configuration 5 (flat long cuttable supports 846)		
Distance to wall: 250-430 mm		
	Max number of straight elements (Ø20) between supports (Size A)	Max. Length from last support. (m) (Size B)
Material	1.4301 / 304; 1.4404 / 316L; 1.4521 / 444; 1.4162 / S32101	
80	2	1.5
100	2	1.5
110	2	1.5
111	2	1.5
120	2	1.5
125	2	1.5
130	2	1.5
139	2	1.5
140	2	1.5
150	2	1.5
153	2	1.5
160	2	1.5
167	2	1.5
175	2	1.5
180	2	1.5
200	2	1.5
230	2	1.5
250	2	1.5
280	2	1.5
300	2	1.5

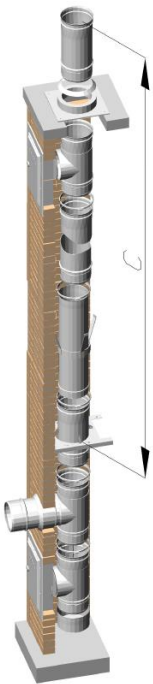

COMPRESSIVE STRENGTH OF THE SUPPORT				
Height (m)				
Model	Adjustable base support closed 853 Size (C)	Adjustable base support extended 853 Size (C)	Adjustable floor support 856*	Roof support 082
80	377	203	197	X
100	302	162	157	
110	274	147	143	
111	272	146	142	
120	251	135	131	
125	241	130	126	
130	232	125	121	
139	217	117	113	
140	215	116	112	
150	201	108	105	
153	197	106	103	87
160	188	101	98	87
167	180	97	94	81
175	172	92	90	79
180	167	90	87	76
200	151	81	78	73
230	131	70	68	69
250	120	65	63	67
280	107	58	56	61
300	100	54	52	53

\*Please check maximum load in the compressive strength table, in case of installing a Tee section on top of our floor support